

# PRM 30W

High performances  
Minimal design  
Integrated driver  
SDCM<3 CRI>90  
Dimming options available

**PRM. 30W** **NN** . **015** **B** **927**

Model Power Dimming Beam angle Body color CCT

## Model

PRM

## Body color

B *Black*  
W *White*

## Power

30W [W]

## CCT

927 2700K  
930 3000K  
940 4000K

## Dimming

NN *none*  
DA *Dali*  
1V *1-10V*  
PM *Potentiometer*  
TR *TRIAC*

## Beam angle

015 [°]  
018 [°]  
024 [°]  
038 [°]  
060 [°]

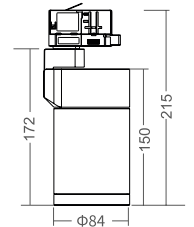

## Features

LED type	CREE
Standard CCT	2700K/3000K/4000K
Other CCT upon request	5000K/6000K
Beam angle	15°/18°/24°/38°/60°

## Performance

Max. delivered output	2771 – 3043lm
Efficacy	92 – 101lm/W

## Electrical and control

Supply type	Main voltage
Input voltage	AC240V
Max. power consumption	30W
Dimming option	See table of codes

## Physical

Housing material	Aluminium
Optics material	PMMA
Weight	1kg
Operating temperature	-25/+55°C

## Accessories

Honeycomb	ACC00506
Cross louver	ACC00507
Barn door	ACC00508
Wall wash ring	ACC00509
Eye snoot	ACC00510
Snoot	ACC00511
Filter - circular small	ACC00517
Filter - circular big	ACC00518
Filter - square	ACC00519
Filter - rectangular	ACC00520
Filter - wall washing	ACC00521

