

PRF004

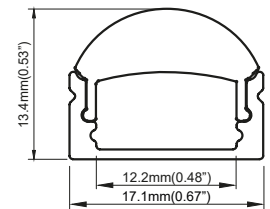
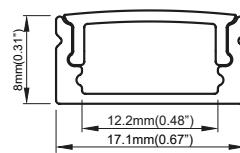

PRF004 **S** . **15** . **OPL**

Model

Finishing
color

Light
surface
width

Cover
type

Model

PRF004

Finishing color

S Silver

Light surface width

15mm

Cover type

OPL *Opal*

FRS *Frosted*

CLR *Clear*

L60 *Lenticular 60°*

BLK *Black*

Physical

Dimensions 17.1x8mm / 17.1x13.4mm

Material Aluminium

Finishing Anodized

Cover material PMMA

Protective degree IP20

Mounting Surface

Accessories

End cap ECAP00005

End cap lenticular 60° ECAP00006

Mounting clip CLIP00004

Adjustable clip CLIP00005

Straight connector JOIN00001

